

## M23611

BRIDA ISO/SAE CÓDIGO 62 SAE J516 / ISO12151-3 6.000 LIBRAS

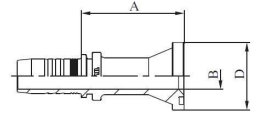

REF.	DIÁMETROS DE MANGUERA			ROSCAS	DIMENSIONES		
	DN	Pulgadas	Tamaño		T	B	A
M23611-08-08	12	1/2"	- 08	1/2"	9,3	52,1	31,8
M23611-08-12	12	1/2"	- 08	3/4"	15,0	68,4	41,5
M23611-10-08	16	5/8"	- 10	1/2"	9,3	52,0	31,8
M23611-10-12	16	5/8"	- 10	3/4"	15,0	70,2	41,5
M23611-10-16	16	5/8"	- 10	1"	20,0	80,0	47,7
M23611-12-12	19	3/4"	- 12	3/4"	15,0	69,0	41,5
M23611-12-16	19	3/4"	- 12	1"	20,0	81,0	47,7
M23611-16-16	25	1"	- 16	1"	19,8	82,3	47,7
M23611-16-20	25	1"	- 16	1.1/4"	26,0	89,8	54,2
M23611-20-16	31	1.1/4"	- 20	1"	20,0	82,5	47,7
M23611-20-20	31	1.1/4"	- 20	1.1/4"	26,0	84,5	54,2
M23611-20-24	31	1.1/4"	- 20	1.1/2"	32,0	90,5	63,7
M23611-24-24	38	1.1/2"	- 24	1.1/2"	32,0	92,6	63,7
M23611-32-32	51	2"	- 32	2"	42,0	107,9	79,6

## M23691

BRIDA 90° ISO/SAE CÓDIGO 62 SAE J516 / ISO12151-3 6.000 LIBRAS

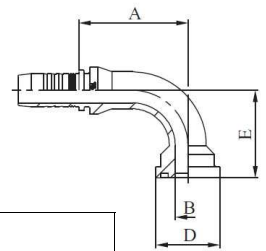

REF.	DIÁMETROS DE MANGUERA			ROSCAS	DIMENSIONES			
	DN	Pulgadas	Tamaño		T	B	A	D
M23691-08-08	12	1/2"	- 08	1/2"	9,3	54,5	31,8	45,0
M23691-08-12	12	1/2"	- 08	3/4"	15,0	54,5	41,5	53,0
M23691-10-08	16	5/8"	- 10	1/2"	9,3	57,5	31,8	45,0
M23691-10-12	16	5/8"	- 10	3/4"	15,0	56,0	41,5	58,0
M23691-10-16	16	5/8"	- 10	1"	19,8	55,7	47,7	65,0
M23691-12-12	19	3/4"	- 12	3/4"	15,0	64,0	41,5	59,0
M23691-12-16	19	3/4"	- 12	1"	20,0	64,5	47,7	65,0
M23691-16-16	25	1"	- 16	1"	19,8	73,5	47,7	68,0
M23691-16-20	25	1"	- 16	1.1/4"	26,0	73,5	54,2	75,0
M23691-20-16	31	1.1/4"	- 20	1"	20,0	82,5	47,7	68,0
M23691-20-20	31	1.1/4"	- 20	1.1/4"	26,0	85,5	54,2	81,0
M23691-20-24	31	1.1/4"	- 20	1.1/2"	32,0	85,5	63,7	91,5
M23691-24-24	38	1.1/2"	- 24	1.1/2"	32,0	106,0	63,7	94,5
M23691-24-32	38	1.1/2"	- 24	2"	42,0	106,0	79,6	110,5
M23691-32-32	51	2"	- 32	2"	42,0	138,0	79,6	132,0